

Discover™ hCG Pregnancy Testing

The Discover hCG Pregnancy Test is a fast, one step test for the qualitative detection of human chorionic gonadotropin (hCG) in urine, as an aid for the early detection of pregnancy.

Midstream

Remove the cap and hold the midstream test by the end capped thumb grip with the exposed absorbent tip pointing downward directly into your urine stream for at least 10 seconds until it is thoroughly wet.



Urine Cassette

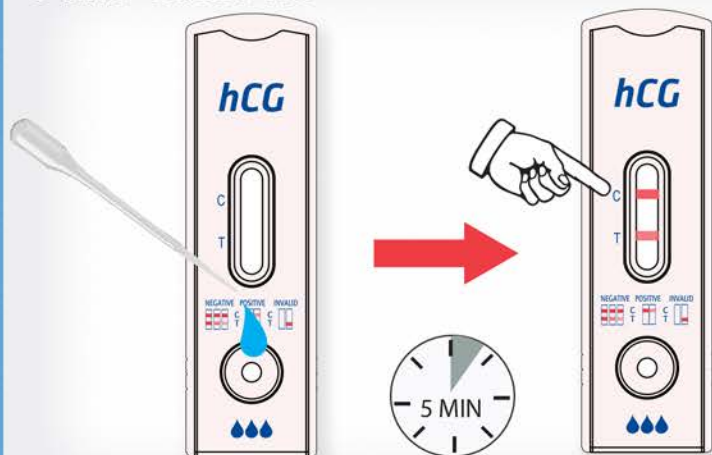

1. Bring the pouch to room temperature before opening. Remove the test device from the sealed pouch and use it as soon as possible.
2. Place the test device on a clean and level surface. Hold the dropper vertically and transfer 3 full drops of urine to the specimen well of the test device. Then start the timer. Avoid trapping air bubbles in the specimen well.
3. Wait for the colored line(s) to appear. The result should be read at 2 to 5 minutes. Lines show up after 10 minutes. It is important that the background is clear before the result is read.

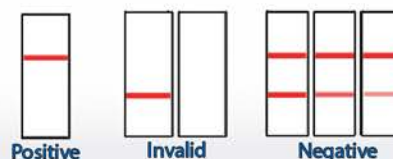

Dip Card

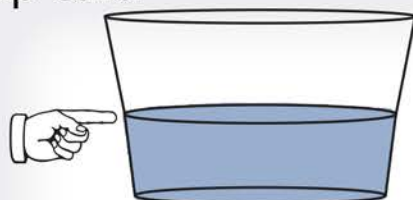

- 1 Equilibrate the test card, urine specimens, and external controls to room temperature (15-30° C) prior to testing.



- 2 Remove the test card from the sealed pouch. Remove cap to expose test strip. Dip the card into the specimen for at least 15 to 20 seconds or until migration occurs. Immerse the strip of the test card just below the top line of the wave line on the test strips, do not dip the cards above the top line.

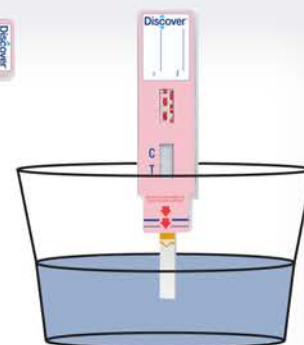
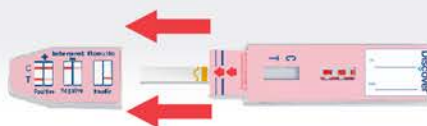

- 3 Replace cap and place the test card on a flat dry surface.

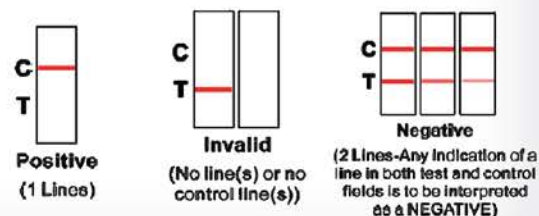

- 4 Read results at 5 minutes. Results stable up to 1 hour.